

# DELTA-O slot channel DN160 - serie SS - Type I

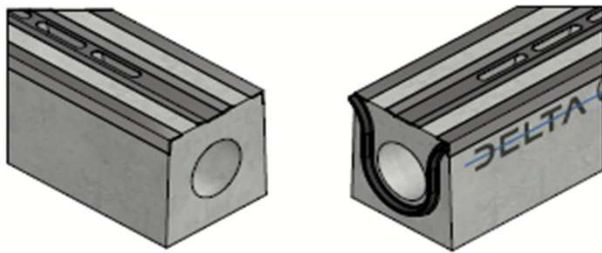

Load class:	D400-E600 of EN1433
Absorption surface cm <sup>2</sup> /m:	177
Slot type:	steel
Edges:	steel
Section cm <sup>2</sup> :	191
Concrete type:	C60/75
Environmental class:	XD3-XF4-XC4-XA3
Durability:	W+R
Length:	2500
Slope:	0
Gradient surface:	0
Connection type:	pressure joint
Lifting:	2 x lifting key
Installation guidelines:	specifications manufacturer
Standard:	in conformity with EN1441
Weight kg:	2190



EPDM pressure joint

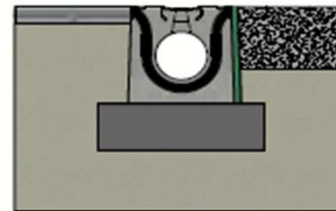

Installation guidelines Type I  
(consult our detailed instructions)





**Technical datasheet**

Art. n°:	DELTA-O1602500SS		
Rev.n°:	0	REV.Date:	05/04/2023







# DELTA-O slot channel DN160 - serie SS - Type I

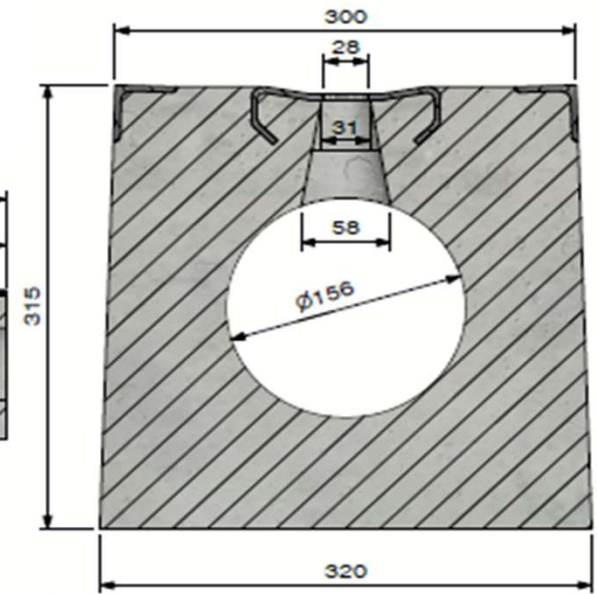
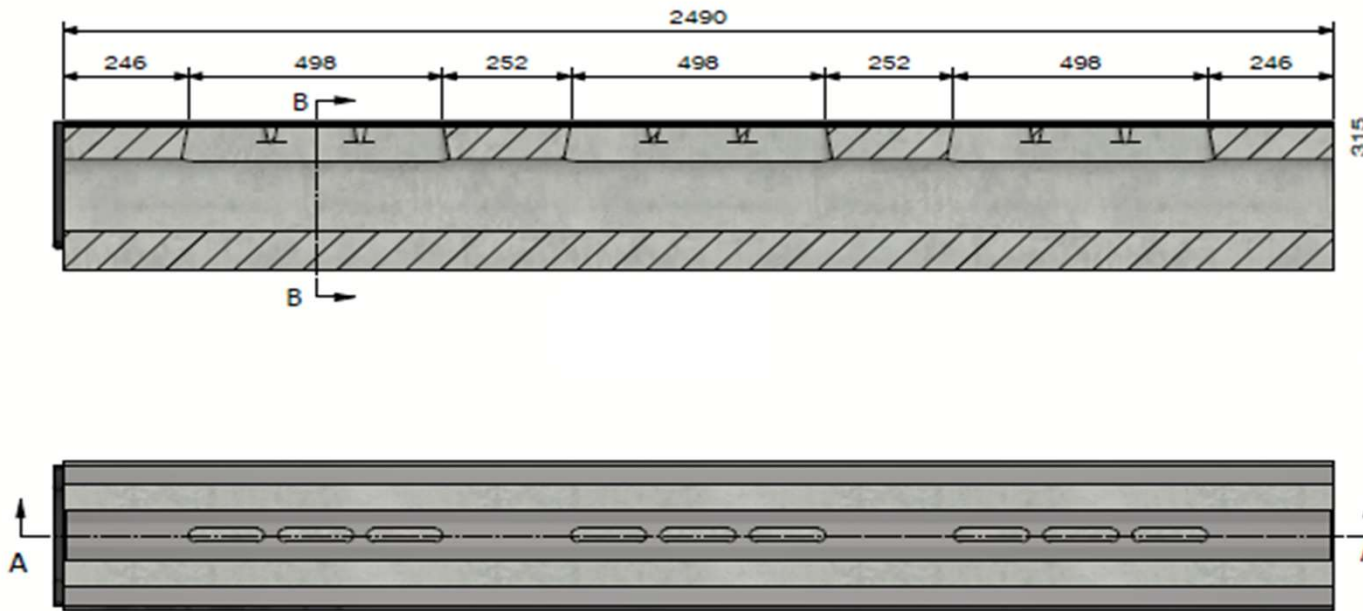

View B





**Technical datasheet**

Art. n°:	DELTA-O1602500SS
Rev.n°:	0
REV.Date:	05/04/2023







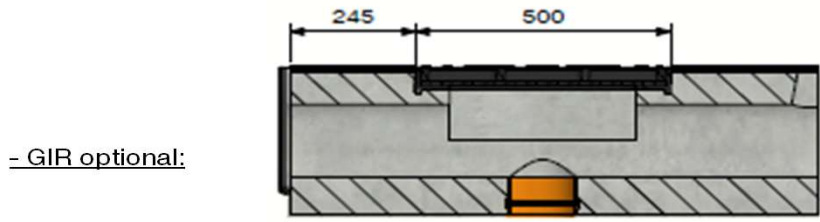

- Integrated inspection grating
- D400-E600
- Sealable
- Bottom drain optional